



# Rock Island

**PROFESSIONAL DEVELOPMENT CENTER**

Policies and Procedures



**Broward County  
Public Schools**

2301 Northwest 26th Street  
Fort Lauderdale, Florida 33311  
754 321-3300 (phone) 754 321-3335 (fax)

# **Welcome to Rock Island Professional Development Center**

## **Policies and Procedures at RIPDC**

**Before a Training**

**Day of the Training**

**Before Leaving Campus**

**General Information**

**Telephones**

**Bathrooms**

**Vending Machines / Lunch**

**Smoking Area**

**Room Set Up**

# Directions to Rock Island Professional Development Center

Rock Island Professional Development Center  
2301 NW 26th Street  
Fort Lauderdale, Florida 33311

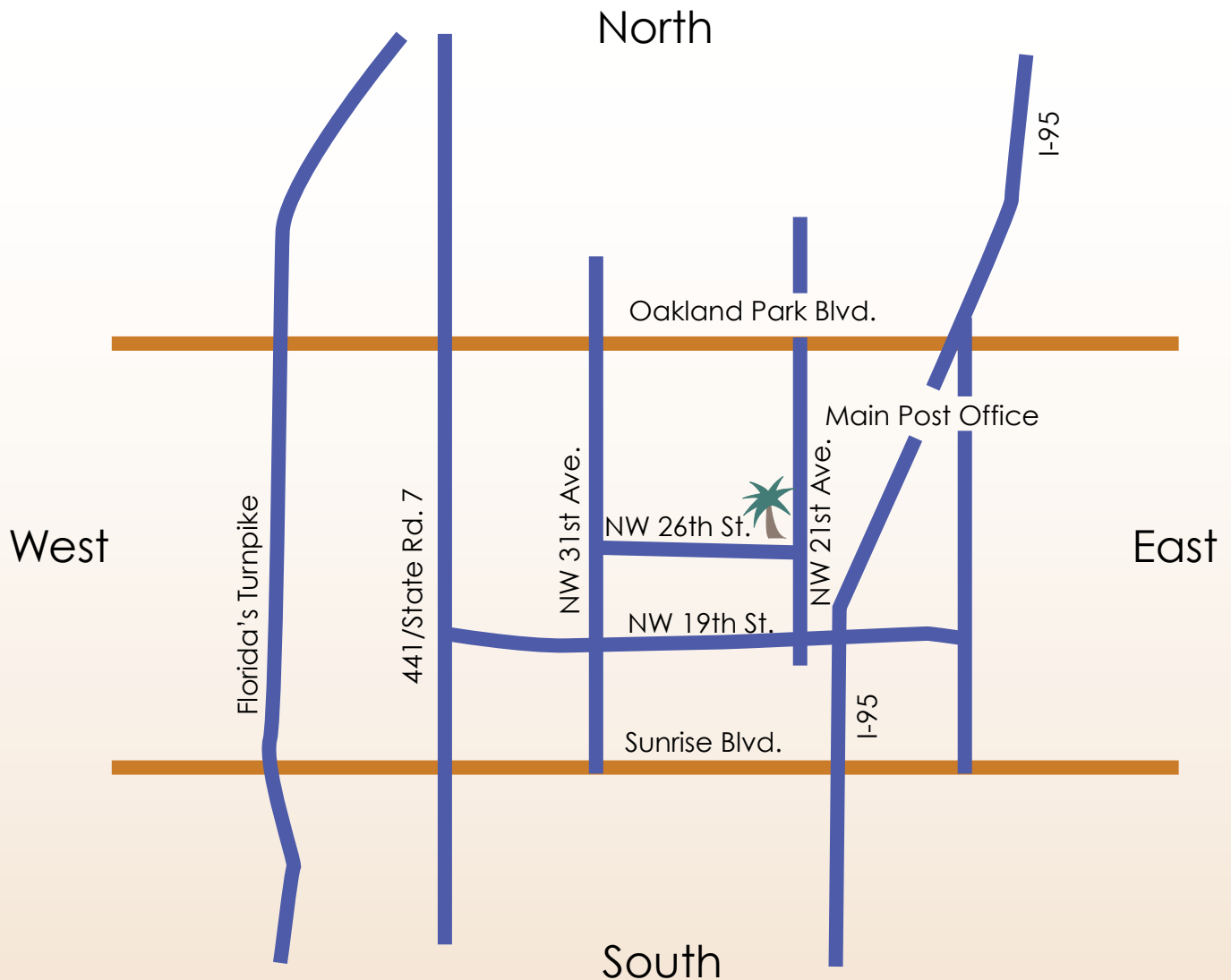

From I-95  
Exit west on Oakland Park Boulevard  
Continue west to NW 21st Avenue  
Go south to NW 26th Street  
Go right (west), Rock Island Professional Development Center will be on the right

# CAMPUS MAP

1204	1203
1202	1201

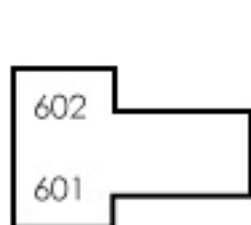

802	804
801	803



209	207	205		
210	208	206	203	RR



401	403	405
402	404	406

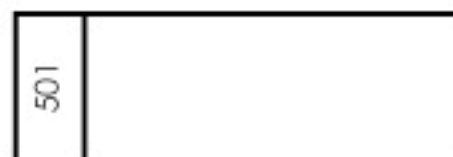



## **Trainer Checklist**

Before you leave, please: